

SUPER MAXI 4000

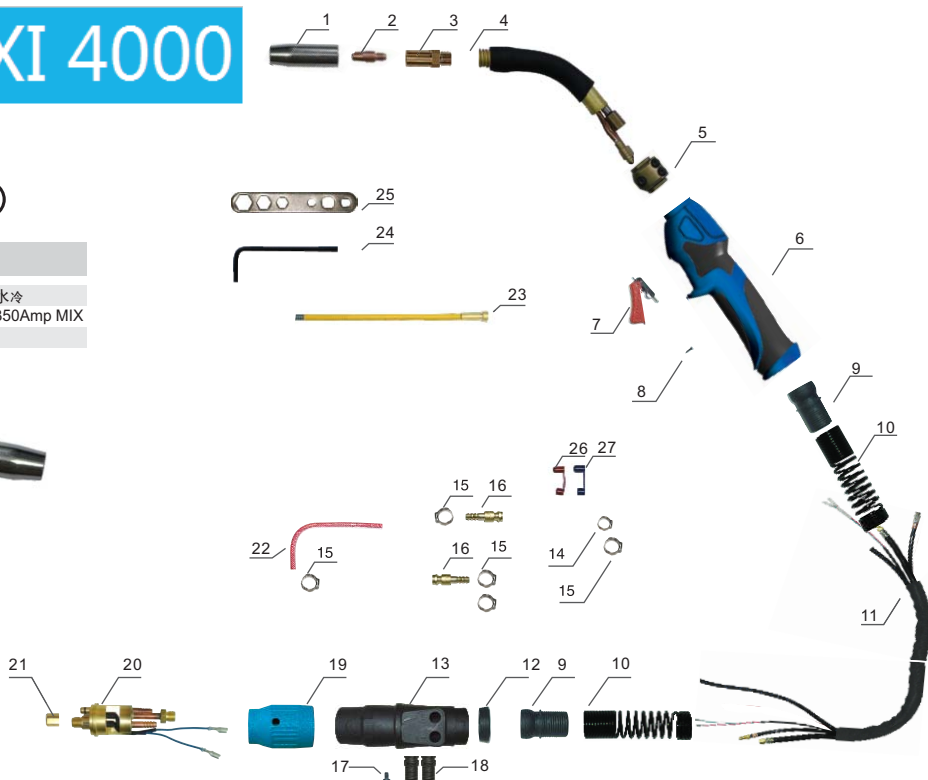

Technical data 技术参数

Cooling 冷却方式	Water Cooled 水冷
Duty cycle 100% 暂载率100%	400Amp CO ₂ , 350Amp MIX
Wire Size 焊丝直径	Φ 1.0-2.4mm



Position	Code	Ref.	Description
1	ICS0067	MC0012	Gas Nozzle Φ 18;喷嘴 Φ 18
2	ICU0005-12	MD0005-12	Contact tip Φ 1.2/M8;导电嘴 Φ 1.2/M8
3	ICF0004	ME0009	Gas diffuser;分流器
4	ICI0061	MG0016	Torch head;枪颈
5	ICG0027	MT0072	Adjusting Block Kit Clamp;定位块
6	ICV0855		Handle;手柄
7	IHQ0070	BX0020	Trigger;焊枪用开关
8	IFT0874		Screw 3.0x16;螺丝 3.0x16
9	IHJ0777	BX0222	Joint for MIG handle;手柄用球头
10	IFT0870	EA0320	Spring cable support;电缆支撑用弹簧
11	ICD0077	MN0022	Cable assenbly;水电缆组
12	IHJ0715	BW0265	Handle closing ring;手柄锁紧环
13	IHJ0763		Back box for water cooled torches;水冷枪后把套
14	IFT0734		Clamp Φ 8.7mm;卡箍 Φ 8.7mm
15	IFT0737		Clamp Φ 9.5mm;卡箍 Φ 9.5mm
16	IZT8070		Quick connector water Φ 6mm;水冷快速插头 Φ 6mm
17	IFT0063		Screw M4x6;螺丝 M4x6
18	IFT0764		Hose support for water cooled rear box;水管支柱
19	IHJ0072		Adaptor nut/Blue;锁紧螺母/蓝色
20	ITB0607	AR0102	Euro centre adaptor/water/maxi/spring pin;欧式中央插头/水冷/MAXI/弹性针
21	IZT0071	IFA0026	Liner nut;送丝管锁紧螺母
22	IKH0605	QB0105	EPDM output water tube Φ 5x8mm 0.8m red;EPDM 出水管 Φ 5x8mm 0.8m Red
23	IIC0590	GM0540	Insulated Steel Liner 1.2-1.6/3m/Yellow;带绝缘层送丝管 1.2-1.6/3m/黄色
24	ICG6007	EA0297	Spanner for pan torch;日式枪用六角扳手
25	ICG6000		Spanner for MIG;MIG 焊枪扳手
26	IHJ0306		Plastic support for water cooling connector red水堵/红色
27	IHJ0308		Plastic support for water cooling connector blue水堵/蓝色
Complete Torch	ICH7898-36	MB2343	MIG MAXI 4000 torch 3m with spring pins;焊枪 MAXI 4000/3m/弹性针
	ICH7899-36	MB2344	MIG MAXI 4000 torch 4m with spring pins;焊枪 MAXI 4000/4m/弹性针
	ICH7895-36	MB2345	MIG MAXI 4000 torch 5m with spring pins;焊枪 MAXI 4000/5m/弹性针

Link Welding Technology Co., Limited

Add: Rm. 19C, Lockhart Ctr., 301-307 Lockhart Rd., Wan Chai, Hong Kong.

Tel: +00852-6735 8659 Fax: +00852-3114 9072 Email: info@linkwelding.com