

SUPER MAXI 250

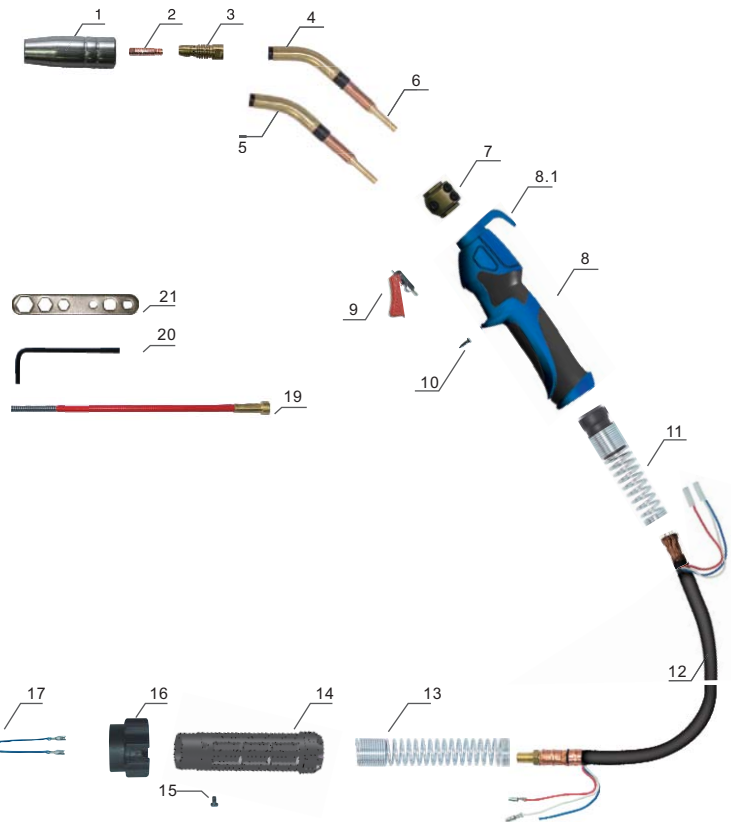

Technical data 技术参数

| | |
|-------------------|-------------------------------------|
| Cooling 冷却方式 | Gas Cooled 气冷 |
| Duty cycle 暂载率60% | 250Amp CO ₂ , 200Amp MIX |
| Wire Size 焊丝直径 | Φ0.8-1.2mm |



| Position | Code | Ref. | Description |
|-----------------------|------------|-----------|------------------------------------------------------------------|
| 1 | ICS0673 | MC0128 | Gas Nozzle Φ16 ;喷嘴 Φ16 |
| 2 | ICU0008-10 | MD0003-10 | Contact tip Φ 1.0;导电嘴 Φ 1.0 |
| 3 | ICF0006 | ME0001 | Gas diffuser ;分流器 |
| 4 | ICZ0629 | | Torch head 45°;枪颈 45° |
| 5 | ICZ0628 | | Torch head 60°;枪颈 60° |
| 6 | ITY0072 | AU0027 | Gas Hose Nipple;接头 |
| 7 | ICG0020 | MT0070 | Adjusting Block Kit Clamp;定位块 |
| 8 | ICV0855-01 | | Handle;手柄 |
| 8.1 | IHJ0672 | | Hanger for handle MAXI250 Φ 16;MAXI 手柄用挂钩MAXI250 Φ 16 |
| 9 | IHQ0070 | BX0020 | Trigger;焊枪用开关 |
| 10 | IFT0874 | | Screw 3.0x10;螺丝 3.0x10 |
| 11 | IHJ0777 | BW0319 | Joint with spring;带弹簧球节 |
| 12 | ICN0798 | MH0243 | Coaxial cable 3m;电缆组 3m |
| 13 | IFT0897-01 | EA0342 | Spring cable Support;支撑弹簧 |
| 14 | IHJ0645 | BW0195 | Back box;后把套 |
| 15 | IFT0063 | EA0018 | Screw M4x6;螺丝 M4x6 |
| 16 | IHJ0070 | BW0020 | Gun plug nut;焊枪锁紧螺母 |
| 17 | ITB0038 | AR0083 | Central adaptor TW/Euro M12x1/Spring pins;中央接头 TW/Euro M12x1/弹性针 |
| 18 | IZT0072 | FA0027 | Liner nut M11x1;送丝管锁紧螺母 M11x1 |
| 19 | IIC0067-06 | | Steel line 3.0m 0.8-0.9mm;送丝管 3.0m 0.8-0.9mm |
| 20 | ICG6007 | | Spanner for Pan torch;日式枪用六角扳手 |
| 21 | ICG6000 | | Spanner for MIG;MIG 焊枪扳手 |
| Complete Torch | | | |
| | ICT1715-36 | MA6265 | MIG MAXI 250 torch 3m with spring pins;焊枪 MAXI 250/3m/弹性针 |
| | ICT1711-36 | MA6266 | MIG MAXI 250 torch 4m with spring pins;焊枪 MAXI 250/4m/弹性针 |
| | ICT1712-36 | MA6267 | MIG MAXI 250 torch 5m with spring pins;焊枪 MAXI 250/5m/弹性针 |

Link Welding Technology Co., Limited

Add: Rm. 19C, Lockhart Ctr., 301-307 Lockhart Rd., Wan Chai, Hong Kong.

Tel: +00852-6735 8659 Fax: +00852-3114 9072 Email: info@linkwelding.com