

SUPER MAXI 150

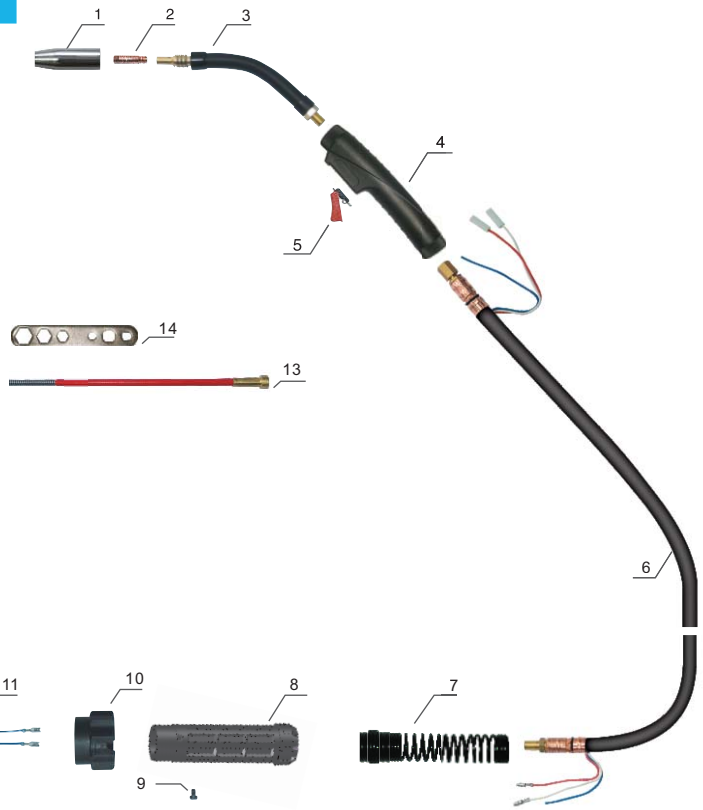

Technical data 技术参数

Cooling 冷却方式	Gas Cooled 气冷
Duty cycle 60% 暂载率60%	180Amp CO ₂ , 140Amp MIX
Wire Size 焊丝直径	Φ0.6-1.2mm



Position	Code	Ref.	Description
1	ICS0001	MC0006	Gas Nozzle Φ14 ;喷嘴 Φ14
2	ICU0003-08	MD0008-08	Contact tip Φ 0.8;导电嘴 Φ 0.8
3	ICZ0007	MF0002	Torch head ;枪颈
4	ICV0057	MP0052	Handle ;手柄
5	IHQ0070	BX0020	Trigger;焊枪用开关
6	ICN0860	MH0310	Coaxial cable ;电缆组
7	IFT0897	EA0342	Spring cable support;支撑弹簧
8	IHJ0645	BW0195	Back box;后把套
9	IFT0063	EA0018	Screw;螺丝
10	IHJ0063	BW0018	Adaptor nut;焊枪锁紧螺母
11	ITB0038	AR0083	Central adaptor TW/Euro M12x1/Spring pins;中央接头 TW/Euro M12x1/弹性针
12	IZT0072	FA0027	Liner nut M11x1;送丝管锁紧螺母 M11x1
13	IIC0066-03		Steel liner 3.4m 0.8-1.0mm;送丝管 3.4m 0.8-1.0mm
14	ICG6000		Spanner for MIG;MIG 焊枪扳手
Complete Torch			
	ICT1615	MA6165	MIG MAX150 torch 3m Euro/TW with spring pins;焊枪 MAX150/3m/弹性针/欧式
	ICT1611	MA6166	MIG MAX150 torch 4m Euro/TW with spring pins;焊枪 MAX150/4m/弹性针/欧式
	ICT1612	MA6167	MIG MAX150 torch 4.6m Euro/TW with spring pins;焊枪 MAX150/4.6m/弹性针/欧式

Link Welding Technology Co., Limited

Add: Rm. 19C, Lockhart Ctr., 301-307 Lockhart Rd., Wan Chai, Hong Kong.

Tel: +00852-6735 8659 Fax: +00852-3114 9072 Email: info@linkwelding.com