

TORCH P350

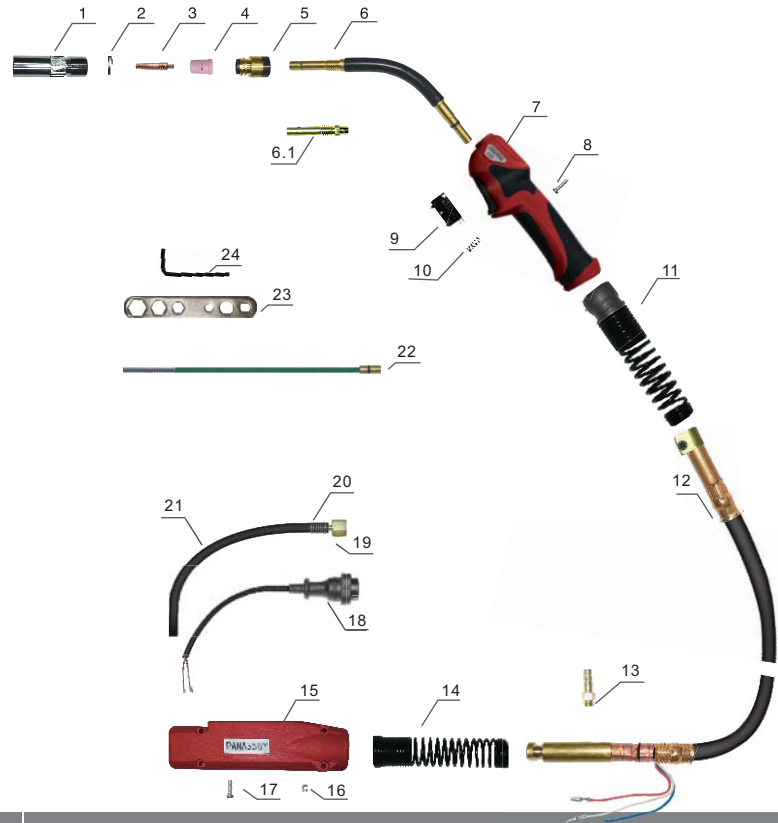

Technical data 技术参数

Cooling 冷却方式	Gas Cooled 气冷
Duty cycle 60% 暂载率60%	340Amp CO ₂ , 320Amp MIX
Wire Size 焊丝直径	Φ0.8-1.6mm



Position	Code	Ref.	Description
1	ICS0496		Nozzle P350; 喷嘴 日式350
2	IFT0668		Grower M21mm; 发黑弹垫 M21mm
3	ICU0746-10		Contact tip Φ 1.0mm E-CU M6x45; 导电嘴Φ1.0mm E-CU M6x45mm
4	ICF0976		Ceramic diffuser P350; 陶瓷分流器 日式350
5	ICS6609		Insulator P350; 绝缘筒 日式350
6	ICZ0749		Torch head P350; 枪颈 日式350
6.1	ICF0971		Torch head front part P350; 枪颈前段 日式350
7	ICV0850		MIG handle P350/500; MIG手柄 日式350/500
8	IFT0874		Screw M3x10mm; 螺丝 M3x10mm
9	IHQ0186		Switch for MIG/PAN; 微动开关/日式枪用
10	IFT0860		Spring for switch/PAN; 弹簧/日式枪微动开关用
11	IZH0864		Joint with spring; 带弹簧球节
12	ICN0188		Coaxial cable 3m; 同轴电缆组/3m
13	IZH7065		Gas connector for MIG torch/PAN; 气管接头/日式
14	IFT0821		Spring cable support; 电缆支撑用弹簧/日式
15	IHJ0640		Back box; 后把套/日式
16	IFT0020		Nut M4; 六角螺母 M4
17	IFT0079		Screw M4x22mm; 螺丝 M4x22mm
18	IHQ0755		Connector 2 holes; 两芯航插/日式/带控制线接头
19	IZT9009		Connector with hexagonal nut 9/16-18; 接头9/16-18六角螺母
20	IFT0803		Spring for gas tube; 气管用弹簧
21	IKH0668		EPDM tube Φ 5×10mm 300mm; EPDM管Φ 5×10mm 300mm
22	IIC0510		Green steel liner Φ 1.0-1.2mm 3m; 带绝缘层送丝管Φ 1.0-1.2mm/3m/绿色
23	ICG6000		Spanner for MIG torches; MIG 焊枪扳手
24	ICG6007		Spanner for PAN torch; 日式枪用六角扳手
Complete Torch	ICT6230-36		MIG P350 torch 3m PAN; 焊枪350 3m 日式
	ICT6236-36		MIG P350 torch 4m PAN; 焊枪350 4m 日式
	ICT6237-36		MIG P350 torch 5m PAN; 焊枪350 5m 日式

Link Welding Technology Co., Limited

Add: Rm. 19C, Lockhart Ctr., 301-307 Lockhart Rd., Wan Chai, Hong Kong.

Tel: +00852-6735 8659 Fax: +00852-3114 9072 Email: info@linkwelding.com