

TORCH P180



Technical data

技术参数

Cooling 冷却方式	Gas Cooled 气冷
Duty cycle 60% 暂载率60%	200Amp CO ₂ , 160Amp MIX
Wire Size 焊丝直径	Φ 0.8-1.2mm

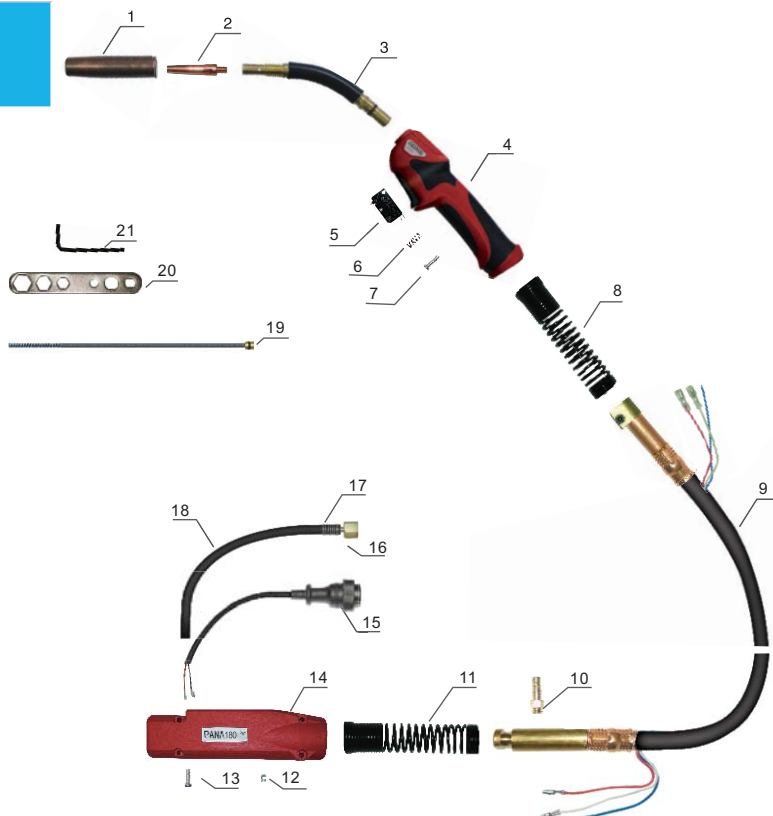

Position	Code	Ref.	Description
1	ICS0456		Nozzle PAN 180;喷嘴/日式180
2	ICU0746-10		Contact tip Φ 1.0 M6x45;导电嘴 Φ 1.0 M6x45
3	ICZ0740		Torch head PAN 180;枪颈/日式180
4	ICV0895		MIG handle PAN180; MIG手柄/日式180
5	IHQ0186		Switch for MIG/PAN;微动开关/日式枪用
6	IFT0860		Spring for switch/PAN;弹簧/日式枪微动开关用
7	IFT0874		Screw M3x10mm;螺丝 M3x10mm
8	IFT0825		Spring cable support;电缆支撑用弹簧
9	ICN0110		Coaxial cable assembling /3m/PAN;同轴电缆组 /3m/日式
10	IZH7065		Gas connector for MIG torch/PAN;日式枪后气管接头
11	IFT0821		Spring cable support/PAN;电缆支撑用弹簧/日式
12	IFT0020		Nut M4;六角螺母 M4
13	IFT0079		Screw M4x20;螺丝 M4x20
14	IHJ0640		Back box for PAN torch;后把套/日式
15	IHQ0755		Connector 2 holes/with connectors/PAN;两芯航插
16	IZT9009		Connector with hexagonal nut 9/16-18;接头带 9/16-18 六角螺母
17	IFT0803		Spring for gas tube;气管用弹簧
18	IKH0668		EPDM tube 5x10 300mm;EPDM管 5x10 300mm
19	IIC0551		Insulated steel liner 0.8-1.0 3.1m Black PAN 180;带绝缘层送丝管 0.8-1.0 3.1m/黑色/日式180
20	ICG6000		Spanner for MIG torches; MIG 焊枪扳手
21	ICG6007		Spanner for PAN torch;日式枪用六角扳手
Complete Torch			
	ICT6531-36		MIG 180 torch 3m PAN;焊枪180 3m 日式
	ICT6532-36		MIG 180 torch 4m PAN;焊枪180 4m 日式
	ICT6533-36		MIG 180 torch 5m PAN;焊枪180 5m 日式

Link Welding Technology Co., Limited

Add: Rm. 19C, Lockhart Ctr., 301-307 Lockhart Rd., Wan Chai, Hong Kong.

Tel: +00852-6735 8659 Fax: +00852-3114 9072 Email: info@linkwelding.com