

TORCH 400/500



Technical data 技术参数400

Cooling 冷却方式	Water Cooled 水冷
Duty cycle 100% 暂载率100%	400Amp CO ₂ , 350Amp MIX
Wire Size 焊丝直径	Φ0.8-1.2mm

Technical data 500 技术参数500

Cooling 冷却方式	Water Cooled 水冷
Duty cycle 100% 暂载率100%	500Amp CO ₂ , 450Amp MIX
Wire Size 焊丝直径	Φ1.0-1.6mm

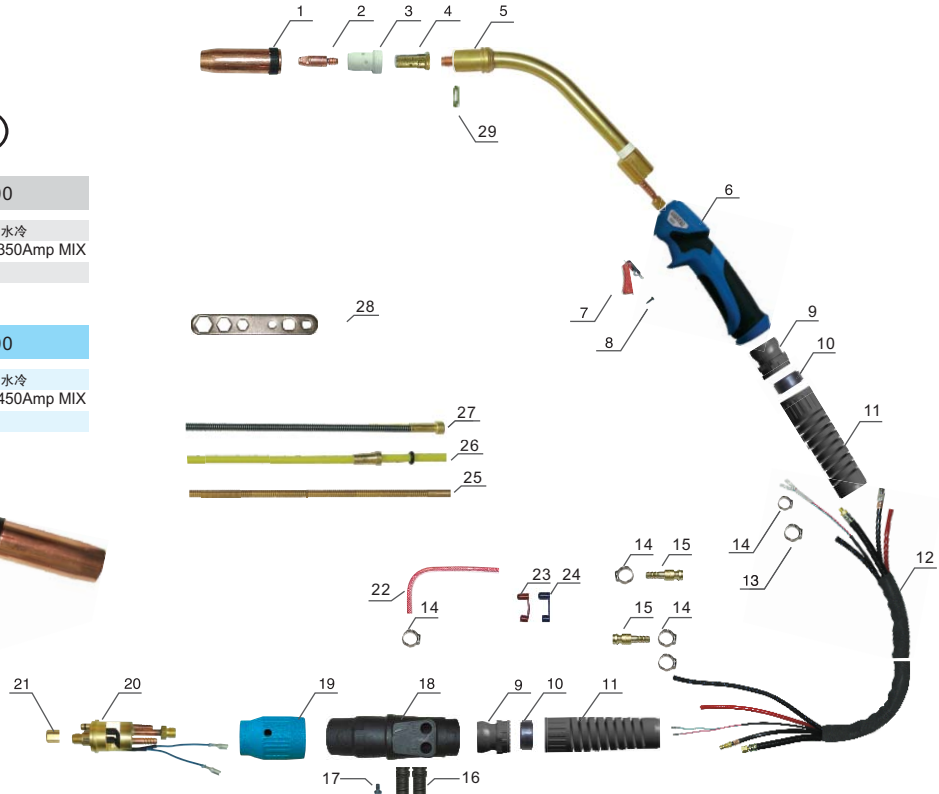

Position	Code	Ref.	Description
1	ICS0713	145.0085	Gas nozzle Φ16mm; 喷嘴Φ16mm
2	ICU0005-12	140.0442	Contact tip Φ1.2mmE-CU/M8x30; 导电嘴Φ1.2mm/M8x30mm
3	ICF0524	030.0190	White ceramic gas diffuser; 白色陶瓷分流器 401D-501D
4	ICF0021	142.0022	Contact tip holder M8x25mm; 导电嘴座/M8x25mm
5			Torch head; 枪颈
5.1	ICI0055	034.0001	Torch head 501D; 枪颈 501D
5.2	ICI0059	033.0001	Torch head 401D; 枪颈 401D
6	ICV0890		MIG handle Blue/Grip; MIG手柄/蓝色
7	IHQ0070	185.0031	Trigger; 焊枪用开关
8	IFT0874		Screw M3x10; 螺丝 M3x10
9	IHJ0021		Joint for MIG handle; MIG手柄用球头
10-1	IHJ0852		HOUSING RING/BIG/INSIDE; 锁紧内环/大
10-2	IHJ0855		HOUSING FOR PLASMA BACK BOX/BIG; 等离子后把套用锁紧环/大
11	IFT0822		Spring for cable support; 电缆支撑弹簧
12	ICD0067		Cable assembly 3m 401D-501D; 水冷电缆组 3m/401D-501D
13	IFT0737	173.0001	Clamp Φ9.5; 卡箍Φ9.5
14	IFT0734	171.0002	Clamp Φ8.7; 卡箍Φ8.7
15	IZT8070	501.0114	Quick connector water Φ6mm; 水冷快速插头Φ6mm
16	IHJ0764		Hose support for water cooled rear box; 水冷枪后把套用水管支柱
17	IFT0063		Screw M4x6; 螺丝 M4x6
18	IHJ0763		Back box for water cooled; 水冷枪后把套
19	IHJ0072		Adaptor nut/Blue; 焊枪锁紧螺母/蓝色
20	ITB0057	501.2156	Euro central adaptor body/water cooling; 欧式水冷中央接头/水冷
21	IZT0071	501.0082	Liner nut; 送丝管锁紧螺母
22	IKH0605		Output water tube M5x8mm 0.8m red; EPDM 编织管 M5x8mm 0.8m/红色
23	IHJ0306		Plastic support for water cooling connector /Red; 水堵/红色
24	IHJ0308		Plastic support for water cooling connector /Blue; 水堵/蓝色
25	IIC0226		Brass terminal Φ3.0x4.5mm 0.35m; 铜送丝管Φ3.0x4.5mm/0.35m
26	IIC0210	126.0039	Teflon liner Φ3.0x4.5mm 3m Yellow; 特氟龙管Φ3.0x4.5mm/3m/黄色
27	IIC0580	122.0056	Steel liner Φ1.2-1.6mm 3m; 钢送丝管Φ1.2-1.6mm/3m
28	ICG6000		Spanner for MIG torches; MIG焊枪扳手
29	IZH6723	030.0019	Insulator 401D-501D; 绝缘垫片 401D-501D
Complete Torch			
	ICH2298-36		MIG 401D torch 3m euro adaptor/spring pins; 焊枪401D/3m/弹性针
	ICH2299-36		MIG 401D torch 4m euro adaptor/spring pins; 焊枪401D/4m/弹性针
	ICH2295-36		MIG 401D torch 5m euro adaptor/spring pins; 焊枪401D/5m/弹性针
	ICH2398-36		MIG 501D torch 3m euro adaptor/spring pins; 焊枪501D/3m/弹性针
	ICH2399-36		MIG 501D torch 4m euro adaptor/spring pins; 焊枪501D/4m/弹性针
	ICH2395-36		MIG 501D torch 5m euro adaptor/spring pins; 焊枪501D/5m/弹性针

Link Welding Technology Co., Limited

Add: Rm. 19C, Lockhart Ctr., 301-307 Lockhart Rd., Wan Chai, Hong Kong.

Tel: +00852-6735 8659 Fax: +00852-3114 9072 Email: info@linkwelding.com