

# TORCH P500

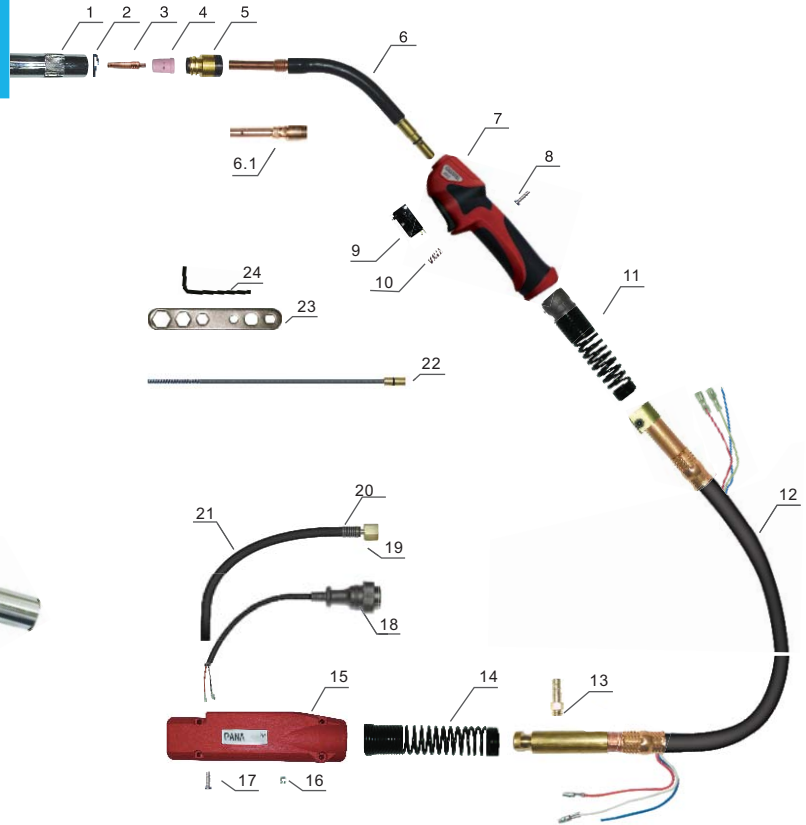

Technical data	技术参数
Cooling 冷却方式	Gas Cooled 气冷
Duty cycle 60% 暂载率60%	500Amp CO <sub>2</sub> , 450Amp MIX
Wire Size 焊丝直径	Φ 0.8-1.6mm



Position	Code	Ref.	Description
1	ICS0457		Nozzle P500; 喷嘴/日式 500
2	IFT0669		Grower M25mm; 发黑弹垫 M25mm
3	ICU0746-12		Contact tip Φ1.2mmE-CU/M6x45; 导电嘴 Φ1.2mm/M6x45mm
4	ICF0978		Ceramic diffuser P500; 陶瓷分流器 日式 500
5	ICS6603		Insulator P500; 绝缘筒/日式 500
6	ICZ0747		Torch head P500; 日式500 枪颈
6.1	ICF0975		Torch head front part P500; 枪颈前段 日式500
7	ICV0850		MIG handle P350/500; MIG手柄 日式350/500
8	IFT0874		Screw M3x10mm; 螺丝 M3x10mm
9	IHQ0186		Switch for MIG/PAN; 微动开关/日式枪用
10	IFT0860		Spring for switch/PAN; 弹簧/日式枪微动开关用
11	IZH0864		Joint with spring; 带弹簧球节
12	ICN0180		Coaxial cable 3m; 同轴电缆组/3m
13	IZH7065		Gas connector for MIG torch/PAN; 气管接头/日式
14	IFT0821		Spring cable support; 电缆支撑用弹簧/日式
15	IHJ0640		Back box; 后把套/日式
16	IFT0020		Nut M4; 六角螺母 M4
17	IFT0079		Screw M4x22mm; 螺丝 M4x22mm
18	IHQ0755		Connector 2 holes; 两芯航插
19	IZT9009		Connector with hexagon nut9/16-18; 接头9/16-18六角螺母
20	IFT0803		Spring for gas tube; 气管用弹簧
21	IKH0668		EPDM tube Φ5×10mm 300mm; EPDM管Φ5×10mm 300mm
22	IIC0518		Black steel liner Φ1.2-1.6mm 3m; 带绝缘层送丝管 Φ1.2-1.6mm/3m/黑色
23	ICG6000	191.0001	Spanner for MIG torches; MIG 焊枪扳手
24	ICG6007		Spanner for PAN torch; 日式枪用六角扳手
<b>Complete Torch</b>	<b>ICT6240-36</b>		<b>MIG P500 torch 3m PAN; 焊枪500 3m 日式</b>
	<b>ICT6246-36</b>		<b>MIG P500 torch 4m PAN; 焊枪500 4m 日式</b>
	<b>ICT6247-36</b>		<b>MIG P500 torch 5m PAN; 焊枪500 5m 日式</b>

Link Welding Technology Co., Limited

Add: Rm. 19C, Lockhart Ctr., 301-307 Lockhart Rd., Wan Chai, Hong Kong.

Tel: +00852-6735 8659 Fax: +00852-3114 9072 Email: info@linkwelding.com